

ICM

CONVEX DETECTION MIRROR

INDOOR

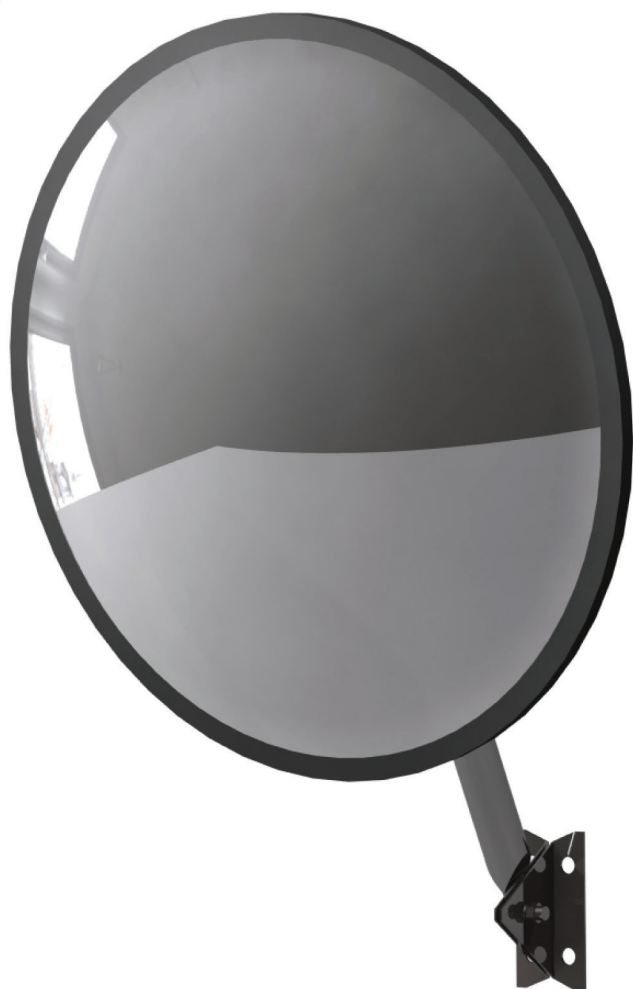

CONVEX FRAME

Provides a wide angled view to see around corners and hidden areas. Helps to reduce accidents and discourages shoplifting.

Recommended to be used for locations where glass mirrors might prove hazardous, as in food processing plants, hospitals, schools institutions and retail stores. Fully adjustable to almost any angle, these mirrors add further security and safety to all retail institutional and industrial applications.

MIRROR

Made from 3mm acrylic. Recommended in locations where glass mirror may not be desired. Convex shape provides panoramic view.

STOCK SIZES

Diameter	Distance Covered
12" (304mm)	10' (3m)
18" (457mm)	25' (7m)
24" (609mm)	35' (10m)
26" (660mm)	40' (12m)
30" (762mm)	45' (13m)
36" (914mm)	
48" (1219mm)	

Custom Sizes Available

Comes complete (all hardware, excluding screws)

ICM CONVEX DETECTION MIRROR

FEATURES

Manufactured with fiberboard backing and sealed edge to protect mirror. Installation hardware includes telescopic arm, swivel hub, and mounting bracket.

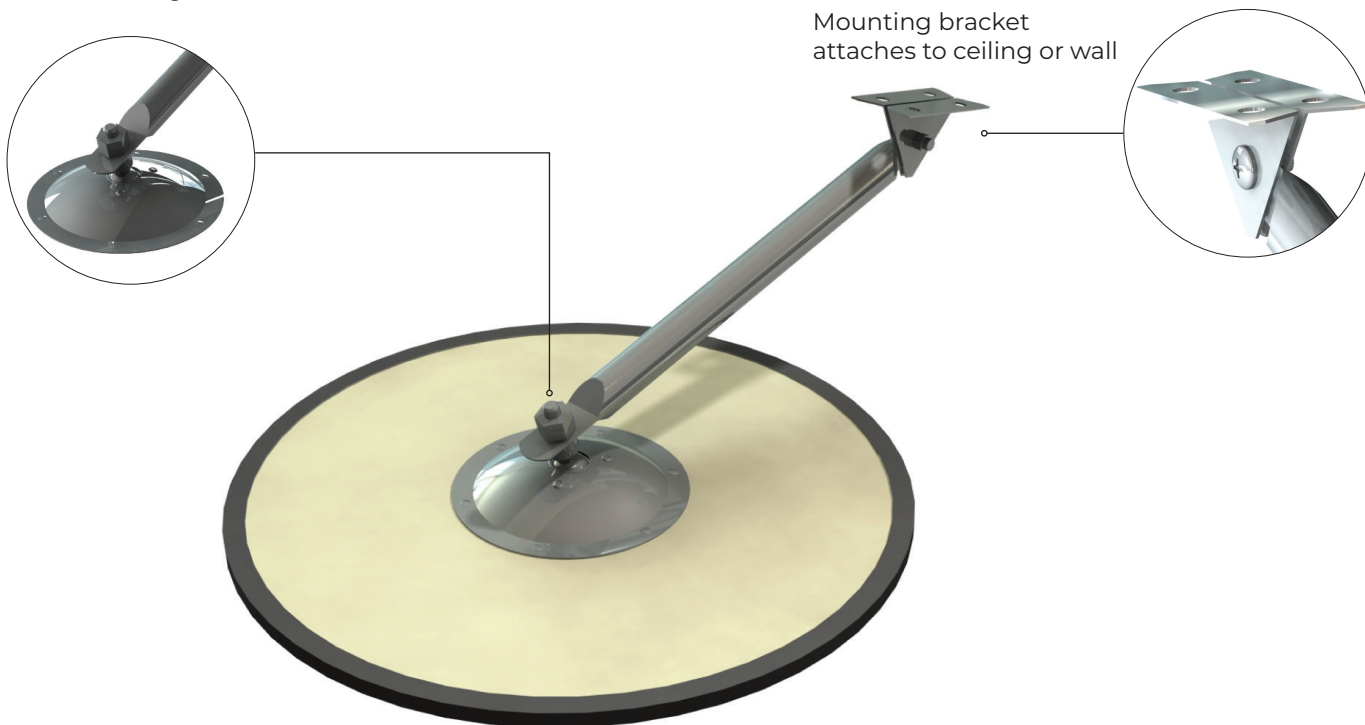

INSTRUCTIONS

- 1 Mount arm(s) in desired location. Requires 4 ea #8 screws.



- 2 Attach arm to swivel ball on hub.

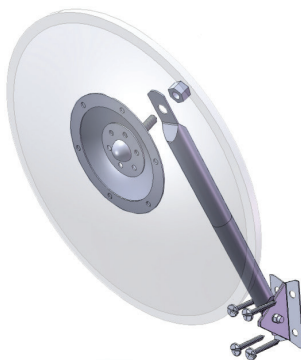

- 3 Back off 1 or 2 screws on hub, 1/2 turn only. Adjust angle of mirror, retighten hub screws.

